

MODEL	APPROX. WEIGHT	
	LB	KG
SF50D-DTTM (DRY)	8400	3850
SF50D-DTTM (WET)	16450	7500

WHEELS: STEEL 16" X 9"
 8 BOLT 6-1/2" B.C.
 TIRES: 235-80R16 10 PLY
 AXLES: TRIPLE 7000#
 SPRINGS: SLIPPER LEAF SPRINGS
 BRAKES: ELECTRIC DRUM
 PLUG: 7-WAY FLAT BLADE
 GVWR: 21000 LBS
 GVWR (LUNETTE EYE): 20000 LBS

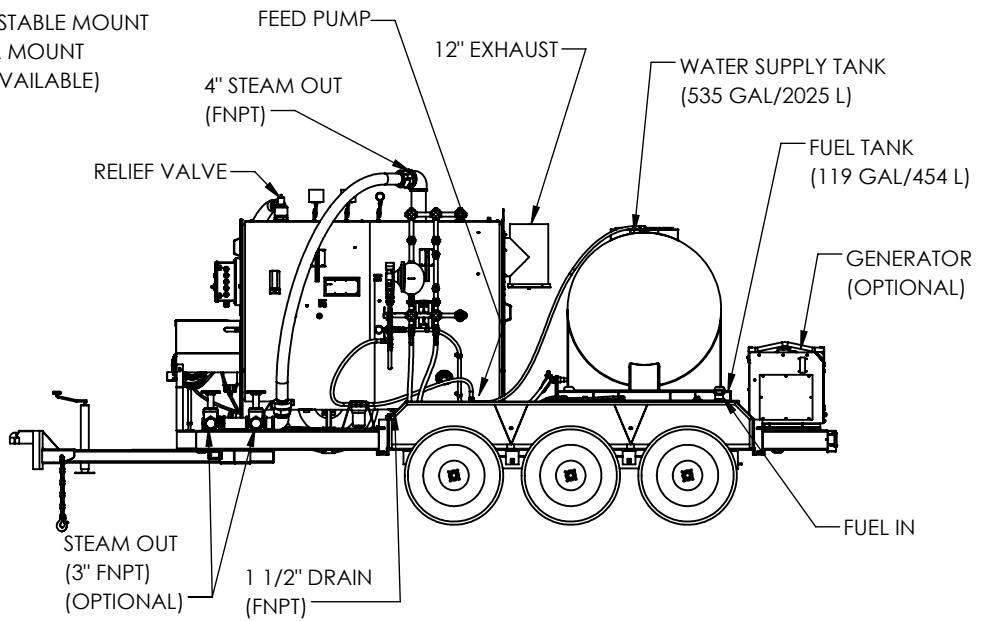
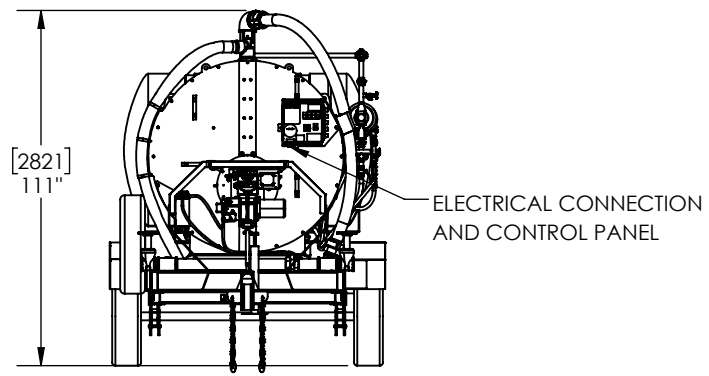
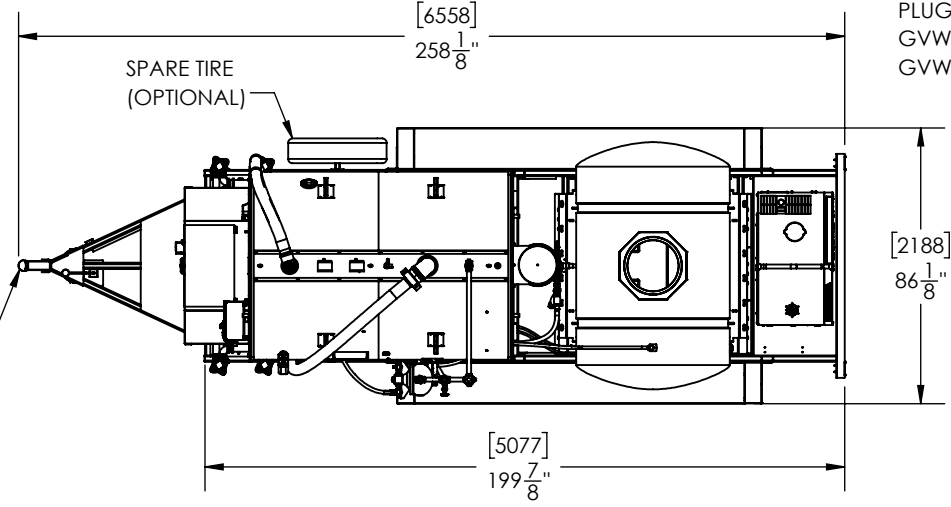
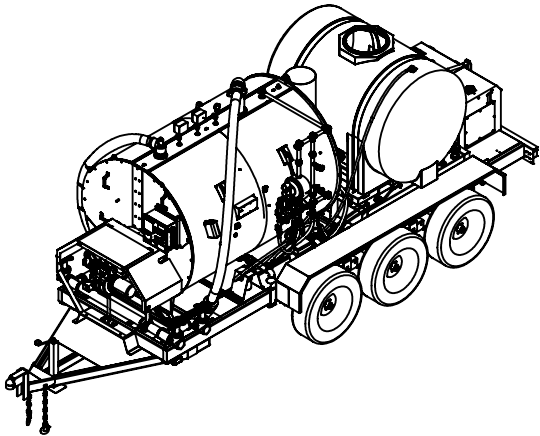

PROPRIETARY AND CONFIDENTIAL
 THE INFORMATION CONTAINED IN THIS DRAWING IS THE SOLE PROPERTY OF SIOUX CORP. ANY REPRODUCTION IN PART OR AS A WHOLE WITHOUT WRITTEN PERMISSION OF SIOUX CORP IS PROHIBITED.
 DO NOT SCALE DRAWING

UNLESS NOTED:
 DIMENSIONS IN INCHES. (mm) FOR REFERENCE ONLY.
 TOLERANCES
 LINEAR: ±1/2"
 ANGULAR: ±2°
 DRN JZ 2/1/2021
 CHK LN 02/01/21
 QC
 THIRD-ANGLE PROJECTION

SIOUX CORPORATION
 ONE SIOUX PLAZA, BERESFORD, SD 57004
 SF50D-DTTM
 GA23903
 SCALE 1:60
 REV A-03 1/1

REV.	DESCRIPTION	DATE	BY
A-03	UPDATED BURNER END PLATE	03/29/23	SB
A-02	UPDATED NOTES/CALLOUTS	08/02/21	JS
A-01	ORIGINAL	02/01/21	LN

DWG. NO. GA23903
 REV. A-03
 SHEET 1/1